

1745-SIGNAL PUSH TO MAKE SWITCH - MOMENTARY

GENERAL ELECTRICAL & MECHANICAL SPECIFICATION

ROHS COMPLAINT

Rating: Momentary	1.0mA @ 24V DC
Life:	>500,000 Cycles
Operating Temperature:	-25 ° C to +100 ° C
Insulation Resistance:	>999 Megohms at 500V DC (Initial)
Contact Momentary	Push to Make
Switch Housing:	Polyamide 6.6 G.F. V0 Rated
Switch Wafer:	Polyamide 6.6 G.F. V0 Rated
Switch Plunger:	Polyamide 6.6 G.F. V0 Rated
Contacts: Momentary	Silver Cadmium Ox + Gold plate
Terminals	Brass CZ108 Sn Plated

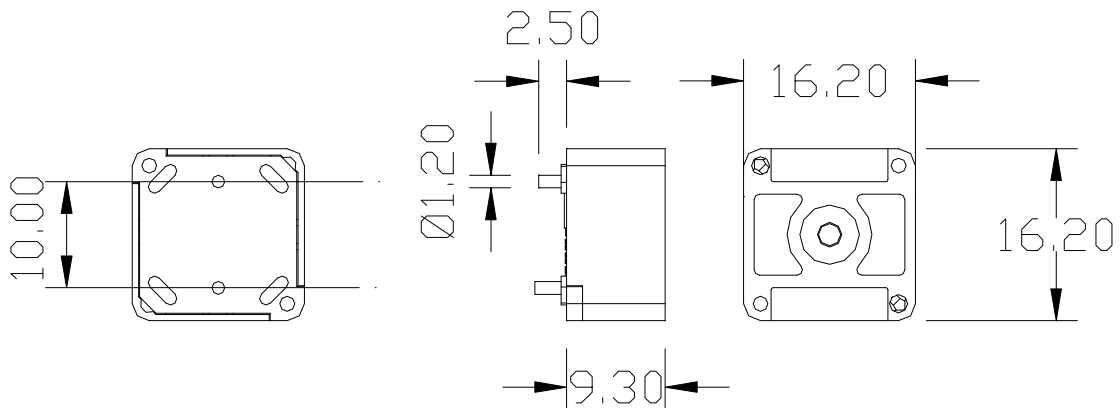
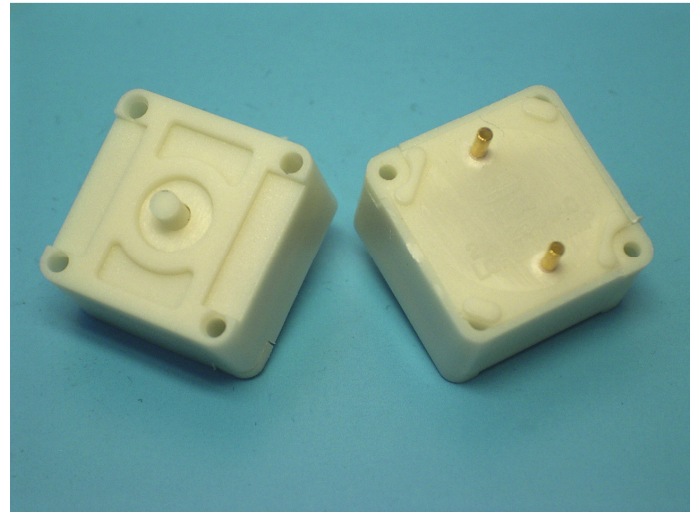

SWITCH MODULE MOMENTARY MAKE

ORDERING CODE

	ORDERING CODE	SWITCH CONFIGURATION	
		TERMINAL	TERMINAL CONFIG
MOMENTARY PUSH TO MAKE	1745-533SAL	PINS	

